

# 平面圖

# Floor Plan

## 5<sup>TH</sup> - 11<sup>TH</sup> FLOOR PLAN



5<sup>TH</sup> - 11<sup>TH</sup> FLOOR AREA TABLE (Square feet)

Floor	WORKSHOP A		WORKSHOP B		WORKSHOP C		WORKSHOP D		WORKSHOP E		WORKSHOP F		WORKSHOP G		WORKSHOP H		WORKSHOP J	
	Gross Area	Schedulable Area	Gross Area	Schedulable Area	Gross Area	Schedulable Area	Gross Area	Schedulable Area	Gross Area	Schedulable Area	Gross Area	Schedulable Area	Gross Area	Schedulable Area	Gross Area	Schedulable Area	Gross Area	Schedulable Area
5 <sup>TH</sup> -11 <sup>TH</sup> F	1,975	1,343	1,875	1,275	1,380	939	1,461	994	1,738	1,182	1,501	1,021	1,423	968	1,345	914	1,432	974
Flat Roof of 5 <sup>TH</sup> F	535		148		110		117		277		96							

Excluding 4/F, 13/F, 14/F and 24/F  
 The internal areas of units on upper floors are in general slightly larger than lower floors due to possible reduced thickness of structural walls on those floors.  
 All given information on this website is for reference only and it is subject to final Government approved plans and documentation.  
 本圖所提供的資料僅供參考，一切內容以政府最後批准圖則及法律文件為準。

## 匯城集團大廈 Reason Group Tower

NOT TO SCALE, FOR IDENTIFICATION PURPOSE ONLY

圖中所有數據比例，一概只作參考之用

# 平面圖

# Floor Plan



## 匯城集團大廈 Reason Group Tower

NOT TO SCALE, FOR IDENTIFICATION PURPOSE ONLY

圖中所有數據比例，一概只作參考之用

# 平面圖

# Floor Plan

20<sup>TH</sup> - 25<sup>TH</sup> FLOOR PLAN



## 匯城集團大廈 Reason Group Tower

NOT TO SCALE, FOR IDENTIFICATION PURPOSE ONLY

圖中所有數據比例，一概只作參考之用



匯城集團大廈 Reason Group Tower

NOT TO SCALE, FOR IDENTIFICATION PURPOSE ONLY

圖中所有數據比例，一概只作參考之用



匯城集團大廈 Reason Group Tower

NOT TO SCALE, FOR IDENTIFICATION PURPOSE ONLY

圖中所有數據比例，一概只作參考之用



匯城集團大廈 Reason Group Tower

NOT TO SCALE, FOR IDENTIFICATION PURPOSE ONLY

圖中所有數據比例，一概只作參考之用



## Information for Reference

Address: 403-413 Castle Peak Road, Kwai Chung, New Territories

Developer: New Able Development Limited

Architect: MLA Architects (HK) Limited

Structural Engineer: Paul Wong Consulting Engineers Limited

Property Management: Jones Lang LaSalle Billion Management Services Limited

Number of Tower: 1

Number of Storey for Industrial Use: 19 storeys  
1/F, 5/F to 25/F; excluding 2/F (Mechanical Rm.) & 3/F (Refuge Floor); there are no 13/F, 14/F, and 24/F

Storey Height (Floor to Floor)\*: 5/F to 25/F: 4 metres for each floor  
\*means the height being measured from one structural floor level to the next structural floor level directly above (where applicable, includes the thickness of the floor slab or roof slabs, all beams, ceiling bulkheads and/ or any concrete structure in between) and subject to final Government approved building plans.)

Number of Private Car Parking Spaces: 27 nos.

Number of Motor Cycle Parking Spaces: 3 nos.

Number of Accessible Car Parking Spaces: 3 nos.

Number of Lorry Parking Spaces: 4 nos. for heavy goods vehicles  
8 nos. for light goods vehicles

## Features

Lobby Entrance: Marble/granite lobby, fully air-conditioned

Building Façade: Reflective glass and curtain wall system

Lifts: 4 high speed passenger lifts; 1 fireman's lift, 2 car lifts

Air-conditioning: Water-cooled packaged air conditioners installed to individual unit and pipe-connected to 24hrs service centralised cooling towers

Floor Loading: 5 kPa

Flooring: Raised floor system

Sprinkler system: Automatic sprinkler system and automatic fire alarm system are provided for the whole building

All given information on this website is for reference only and it is subject to final Government approved plans and documentation.

本網站提供的資料僅供參考，一切內容以政府最後批准圖則及法律文件為準。

## 匯城集團大廈 Reason Group Tower

**NOT TO SCALE, FOR IDENTIFICATION PURPOSE ONLY**

圖中所有數據比例，一概只作參考之用

# 位置圖

# Location Plan

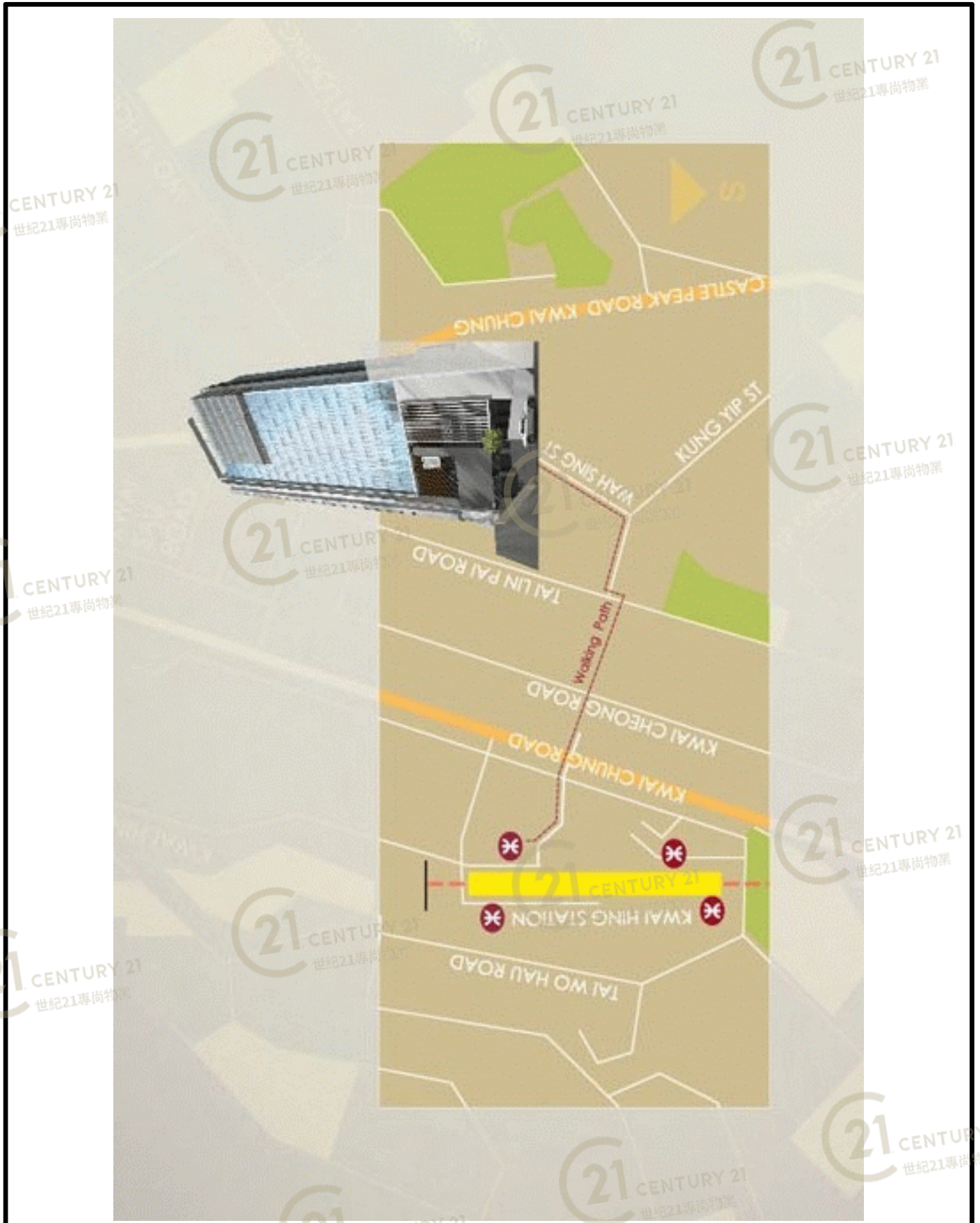

匯城集團大廈 Reason Group Tower

NOT TO SCALE, FOR IDENTIFICATION PURPOSE ONLY

圖中所有數據比例，一概只作參考之用



# 外觀圖

# Building Outlook



匯城集團大廈 Reason Group Tower

NOT TO SCALE, FOR IDENTIFICATION PURPOSE ONLY

圖中所有數據比例，一概只作參考之用

# 平面圖

# Floor Plan

KWAI CHUNG TOWN LOT NO. 110, NEW TERRITORIES.

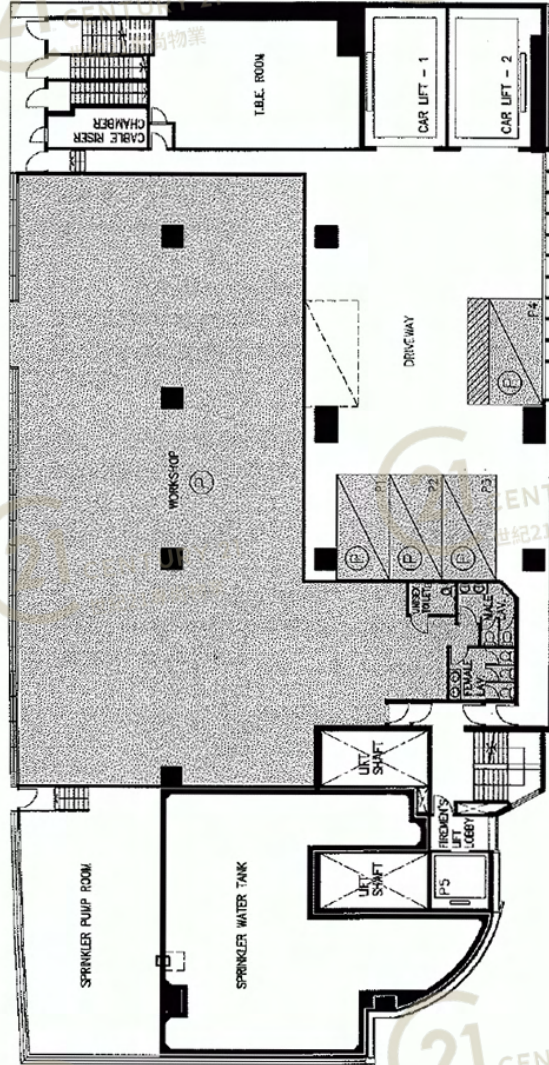

## 1ST FLOOR PLAN

SCALE: 1:300

- NOTES:
1. FOR IDENTIFICATION PURPOSES ONLY.
  2. THIS PLAN IS SUBJECT TO ANY AMENDMENT(S) WHICH MAY BE APPROVED BY THE BUILDING AUTHORITY AND/OR LANDS DEPARTMENT.

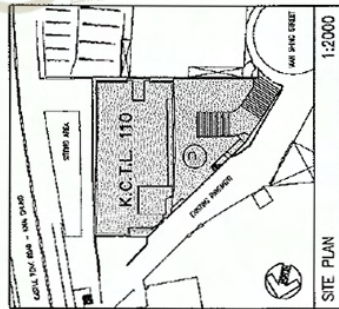

LEGEND:



PINK

UNIT DIAGRAMS:



WORKSHOP

FLOOR

1



PARKING

FLOOR

1

P1

P2

P3

P4

**MLA**  
ARCHITECTS (HK) LTD  
馬梁美亞建築師(香港)有限公司

LEUNG SAI HUNG  
HKIA AUTHORIZED PERSON  
I HEREBY CERTIFY THE ACCURACY OF THIS PLAN.

## 匯城集團大廈 Reason Group Tower

NOT TO SCALE, FOR IDENTIFICATION PURPOSE ONLY

圖中所有數據比例，一概只作參考之用