

平面圖

Floor Plan

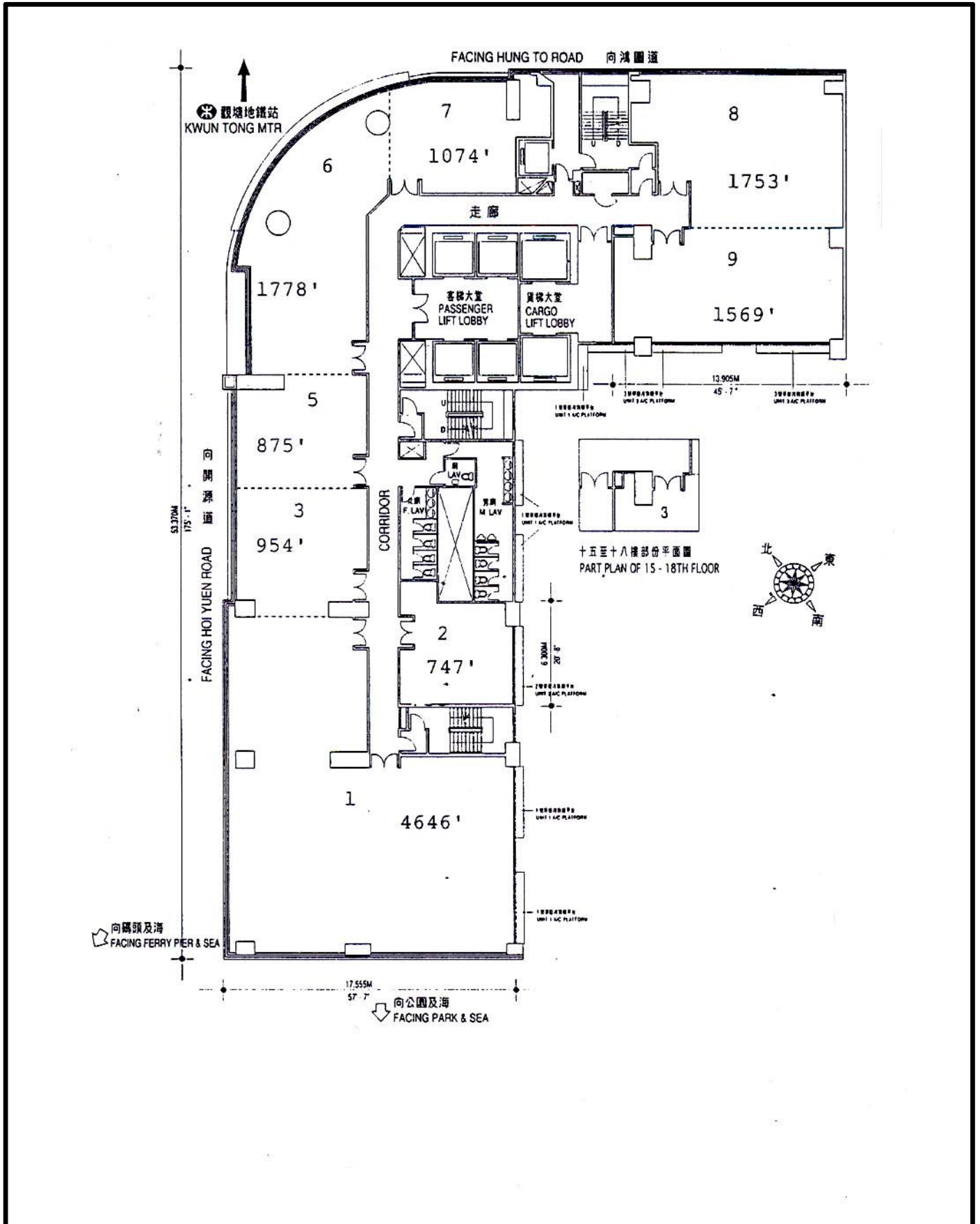

威利廣場 Westley Square

NOT TO SCALE, FOR IDENTIFICATION PURPOSE ONLY

圖中所有數據比例，一概只作參考之用

平面圖

Floor Plan

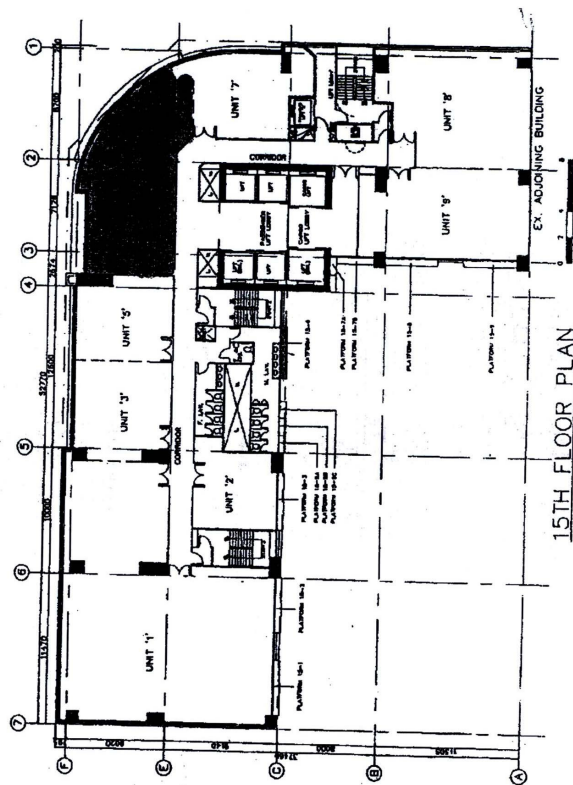
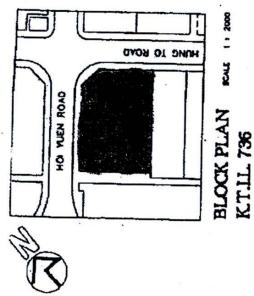

威利廣場 Westley Square

NOT TO SCALE, FOR IDENTIFICATION PURPOSE ONLY

圖中所有數據比例，一概只作參考之用

平面圖

Floor Plan

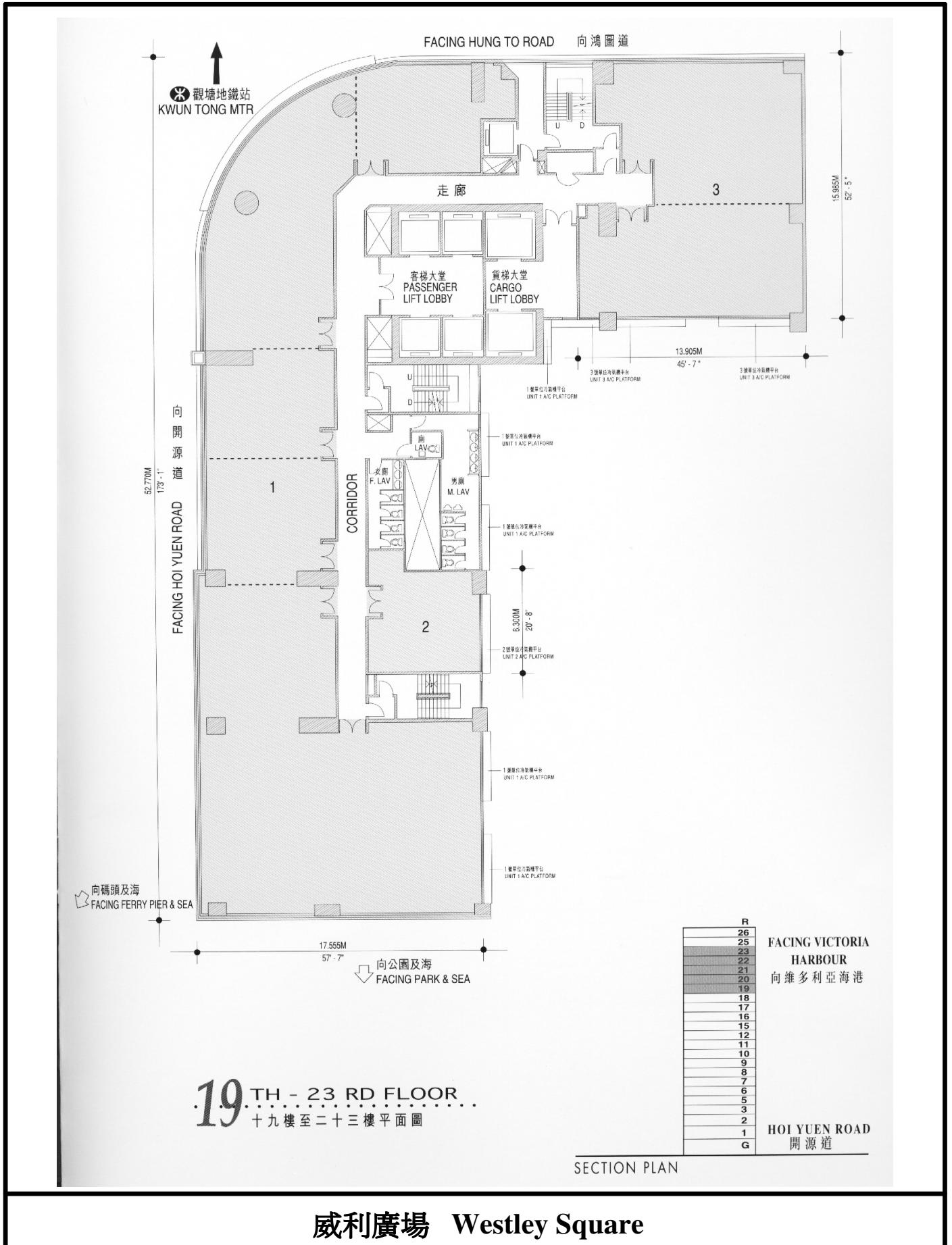

威利廣場 Westley Square

NOT TO SCALE, FOR IDENTIFICATION PURPOSE ONLY

圖中所有數據比例，一概只作參考之用

平面圖

Floor Plan

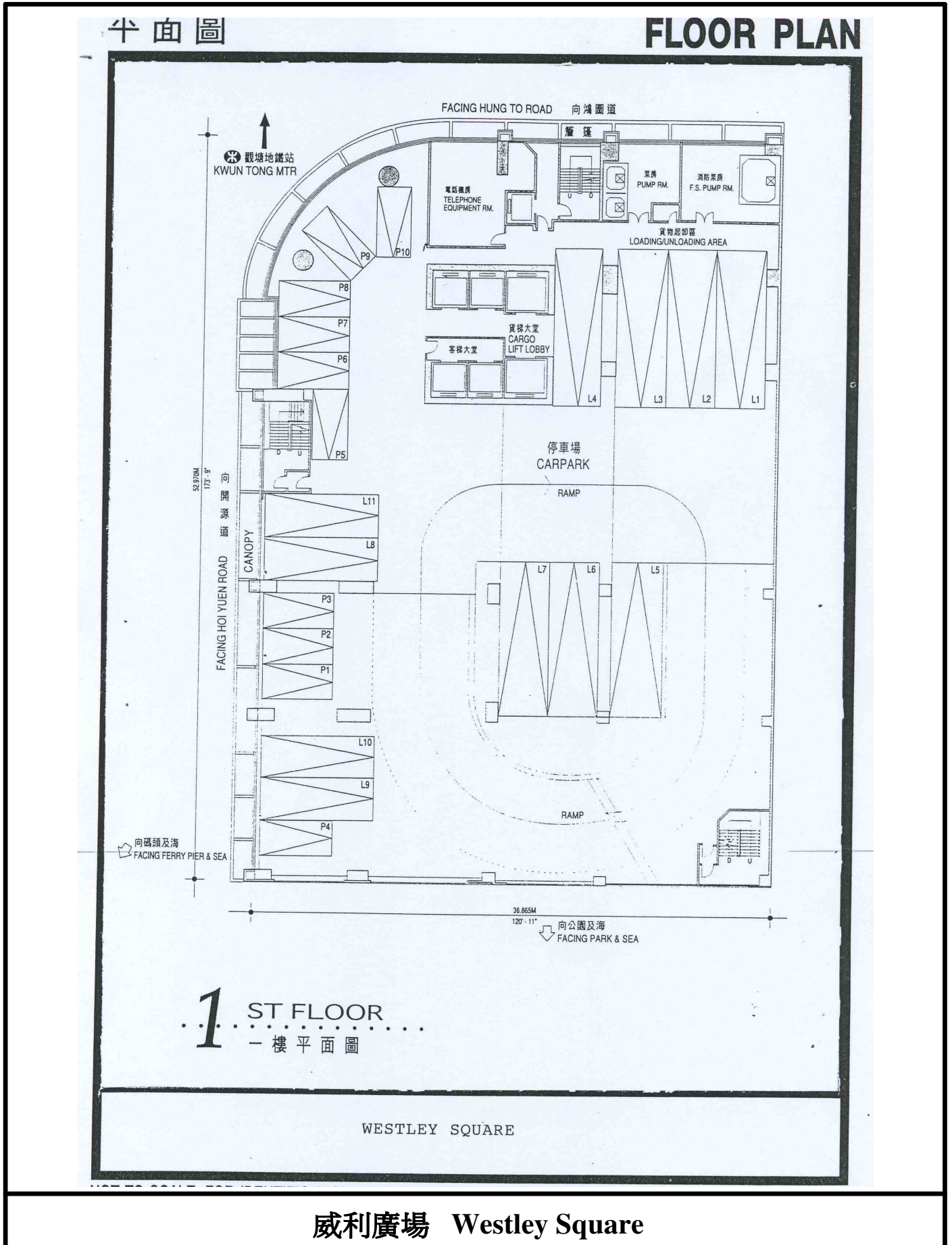

NOT TO SCALE, FOR IDENTIFICATION PURPOSE ONLY

圖中所有數據比例，一概只作參考之用

平面圖

Floor Plan

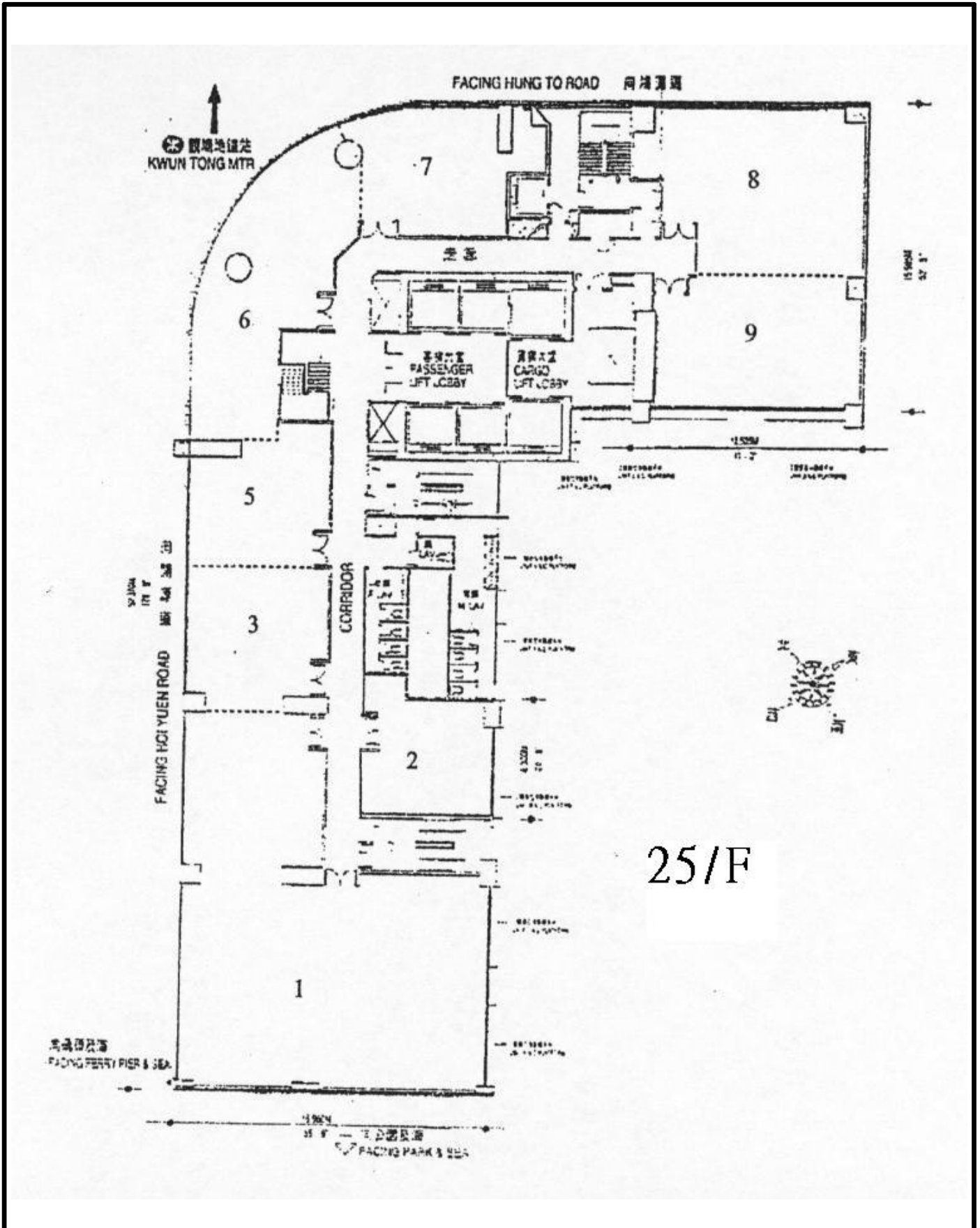

25/F

威利廣場 Westley Square

NOT TO SCALE, FOR IDENTIFICATION PURPOSE ONLY
圖中所有數據比例，一概只作參考之用



平面圖

Floor Plan

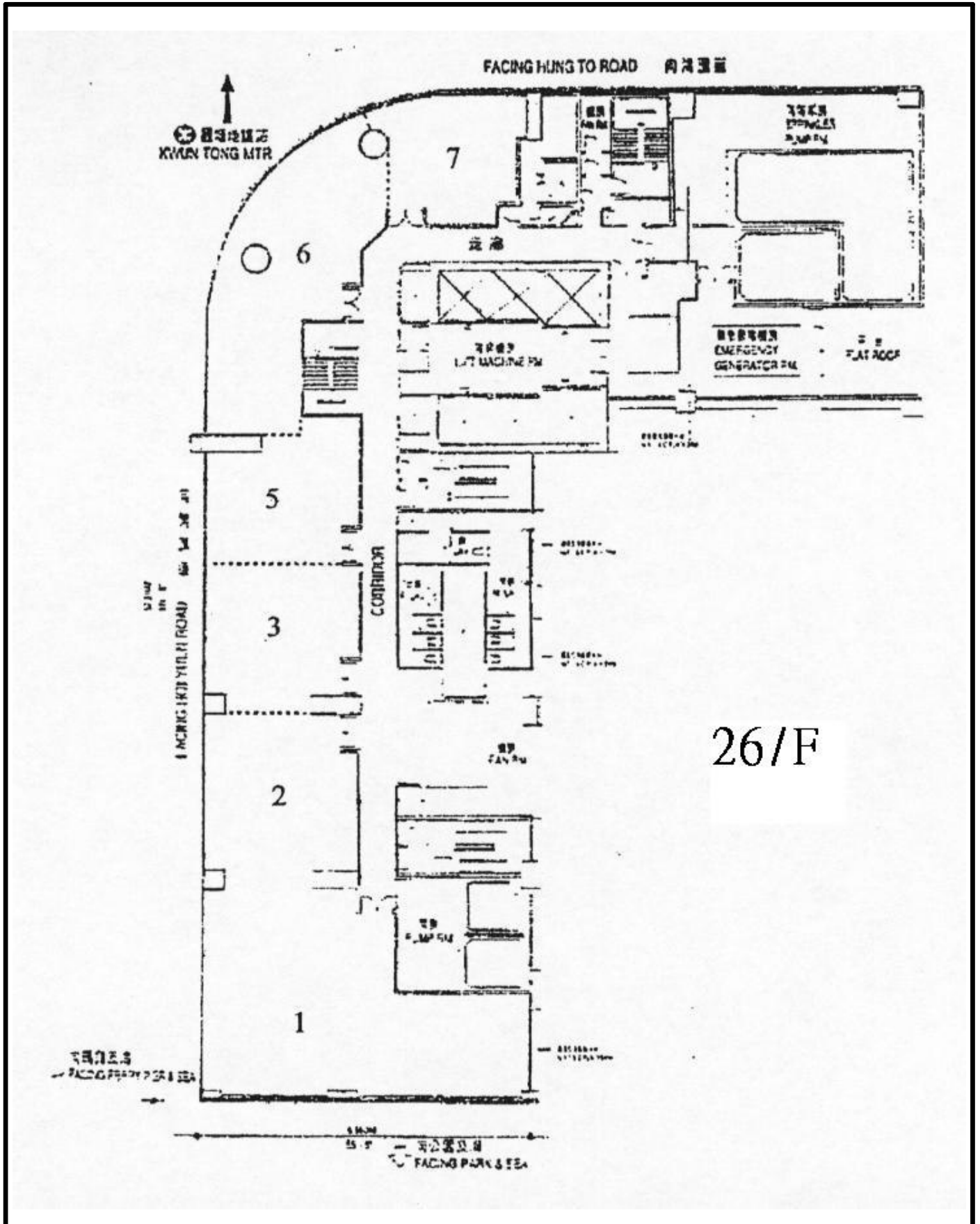

26/F

威利廣場 Westley Square

NOT TO SCALE, FOR IDENTIFICATION PURPOSE ONLY
圖中所有數據比例，一概只作參考之用



平面圖

Floor Plan

平面圖

FLOOR PLAN

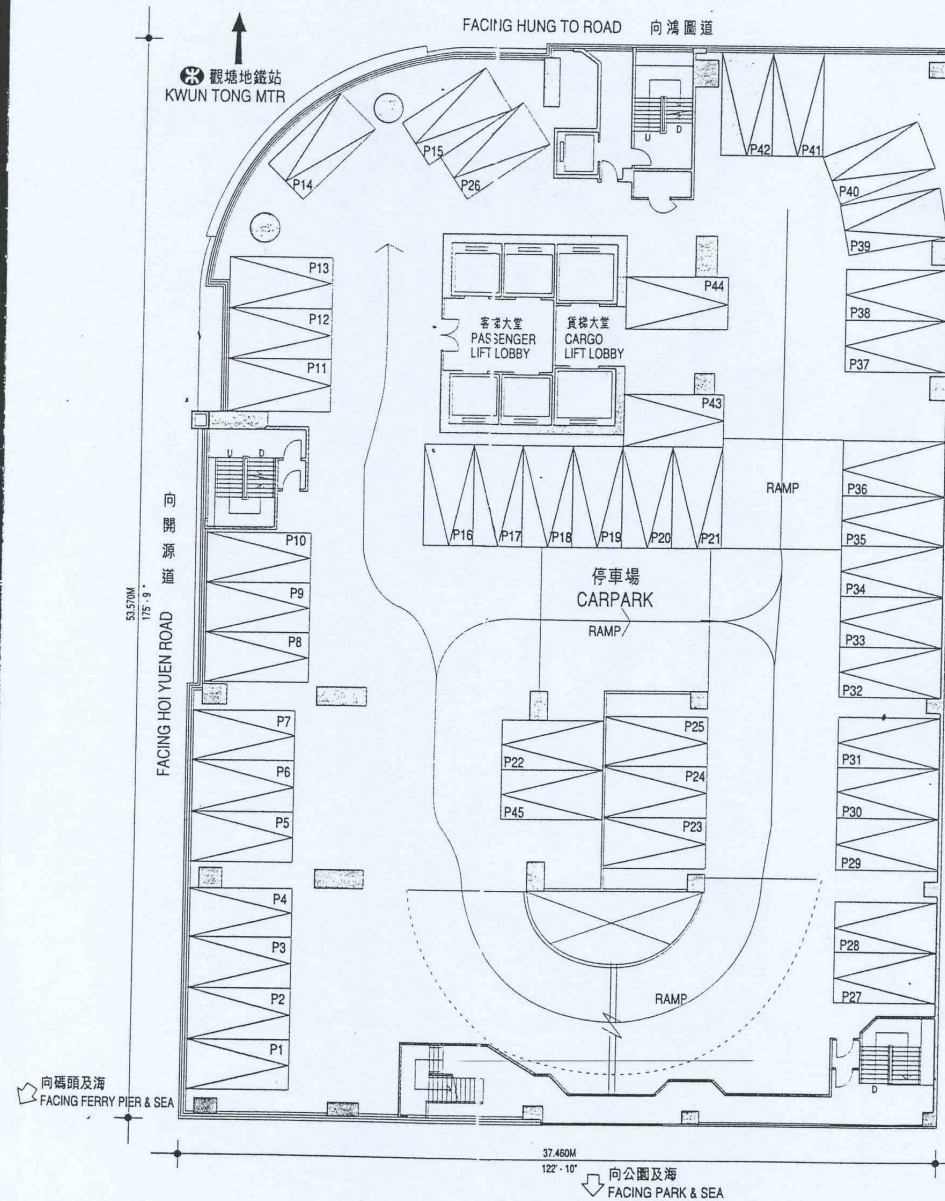

2ND FLOOR
二樓平面圖

WESTLEY SQUARE

NOT TO SCALE, FOR IDENTIFICATION PURPOSE ONLY

威利廣場 Westley Square

NOT TO SCALE, FOR IDENTIFICATION PURPOSE ONLY

圖中所有數據比例，一概只作參考之用

平面圖

Floor Plan

平面圖

FLOOR PLAN

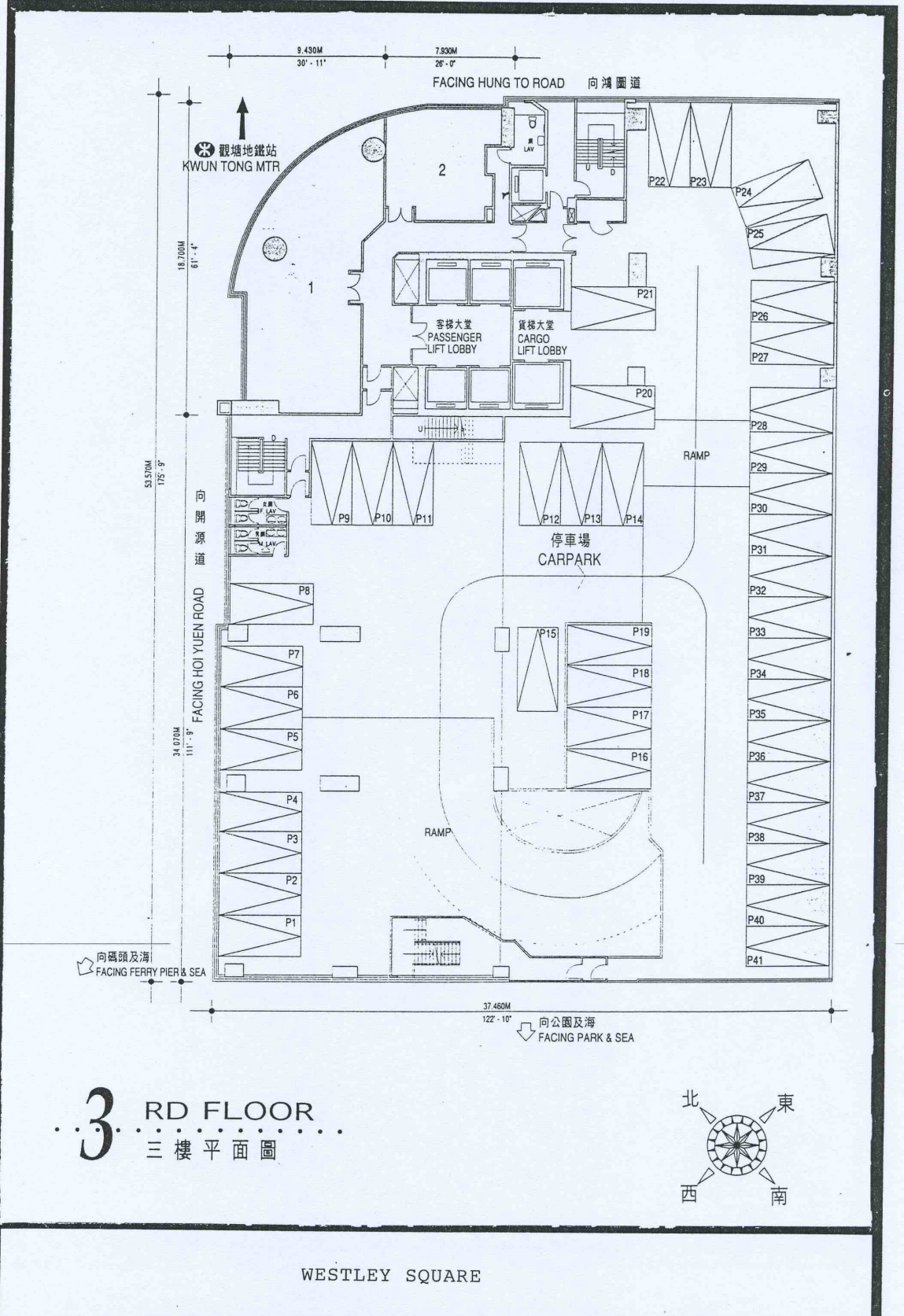

威利廣場 Westley Square

NOT TO SCALE, FOR IDENTIFICATION PURPOSE ONLY

圖中所有數據比例，一概只作參考之用

平面圖

Floor Plan

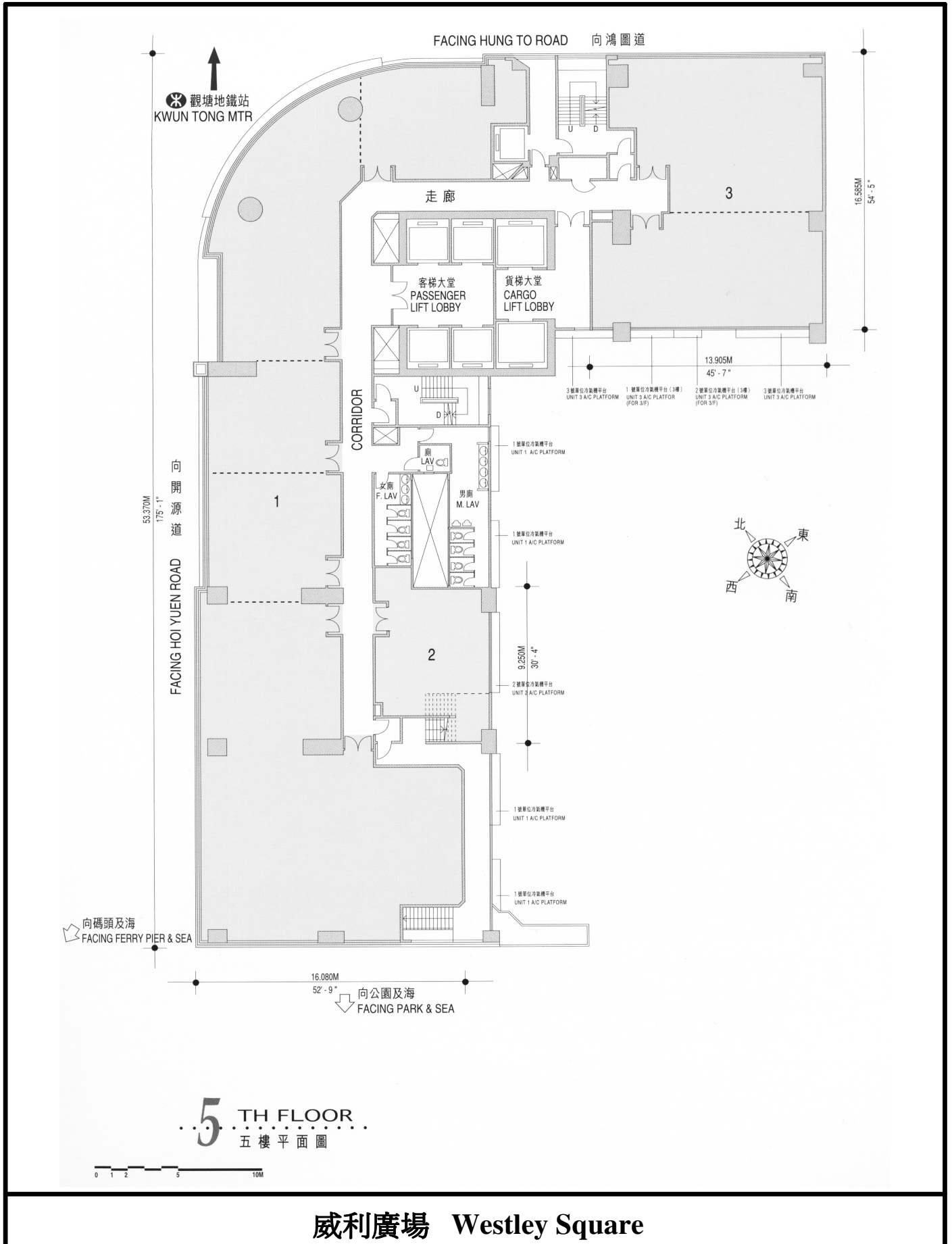

威利廣場 Westley Square

NOT TO SCALE, FOR IDENTIFICATION PURPOSE ONLY

圖中所有數據比例，一概只作參考之用

平面圖

Floor Plan

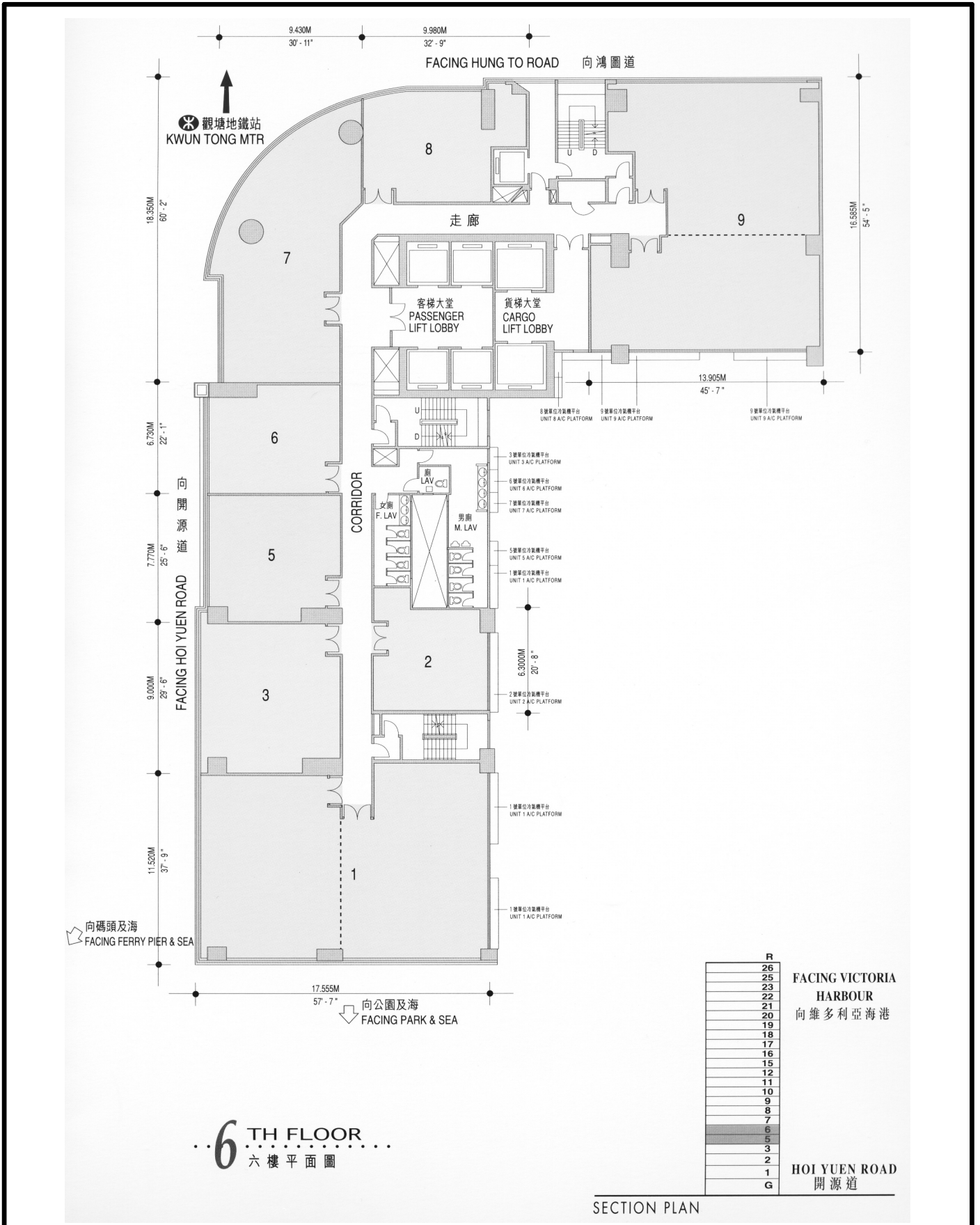

威利廣場 Westley Square

NOT TO SCALE, FOR IDENTIFICATION PURPOSE ONLY

圖中所有數據比例，一概只作參考之用

平面圖

Floor Plan

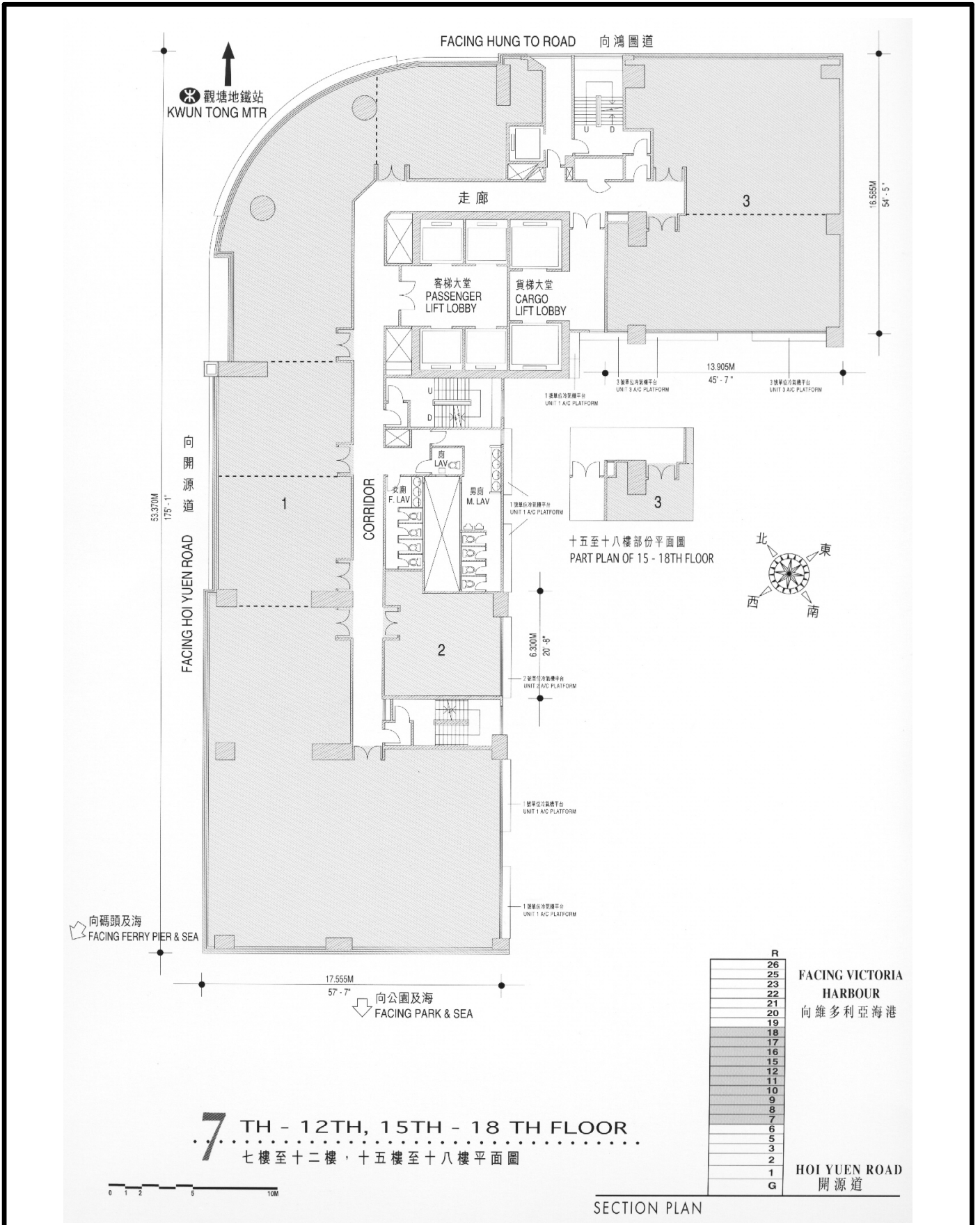

威利廣場 Westley Square

NOT TO SCALE, FOR IDENTIFICATION PURPOSE ONLY

圖中所有數據比例，一概只作參考之用

平面圖

Floor Plan

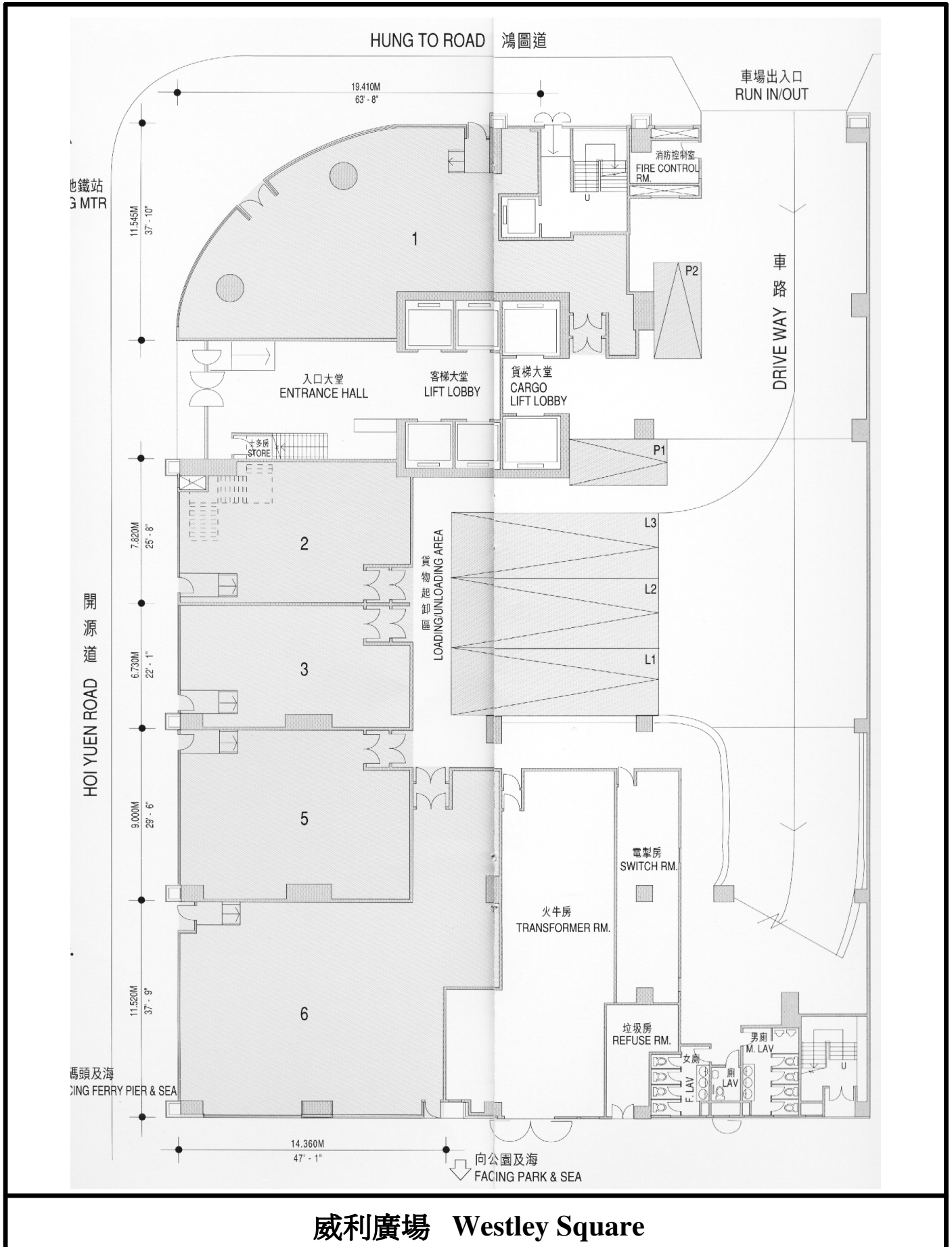

NOT TO SCALE, FOR IDENTIFICATION PURPOSE ONLY

圖中所有數據比例，一概只作參考之用

平面圖

Floor Plan

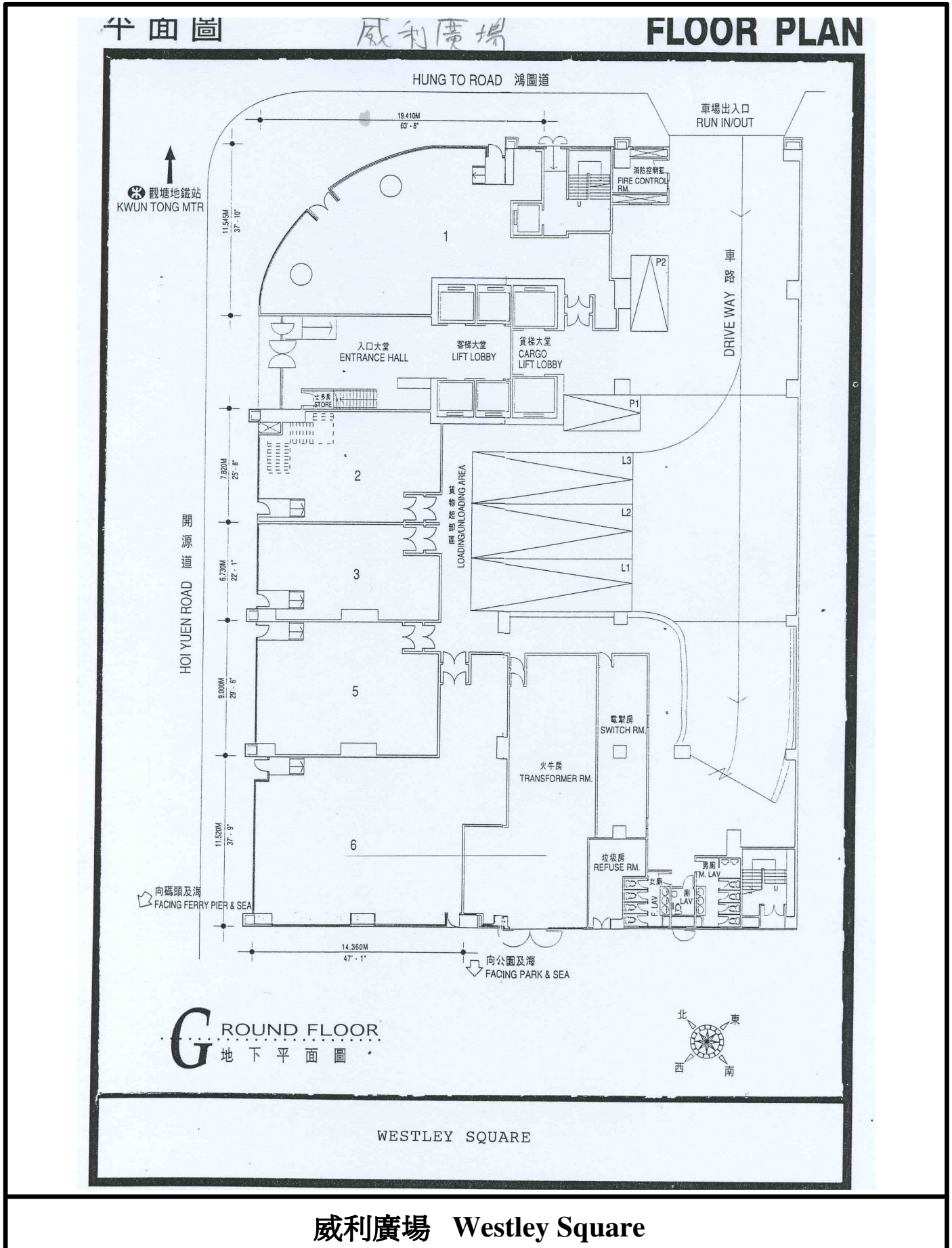

威利廣場 Westley Square

NOT TO SCALE, FOR IDENTIFICATION PURPOSE ONLY

圖中所有數據比例，一概只作參考之用

平面圖

Floor Plan

[Floor Plan - Westley Square \(Typical\)](#)
[Floor Plan - Westley Square \(Ground Floor\)](#)
[Location Map - Westley Square](#)

Westley Square (威利廣場) 48 Hoi Yuen Road, Kwun Tong, Kowloon

Industrial/Office					Remarks
Floor 樓層	Unit 單位	M.F.A. (s.f.) 建築面積	Monthly Rental 月租	P.S.F. 呎租	
G/F	3	1,487	\$37,175	\$25.00	電錶
G/F	6A	2,432	\$60,800	\$25.00	
G/F	6B	1,420	\$32,660	\$23.00	
9/F	2	747	\$9,338	\$12.50	Expire on 15/5/08
15/F	9	1,574	\$18,888	\$12.00	Bare-shell (60A單相電)

Total 7,660

G/F	5	1,982	\$49,550	\$25.00	Terminate on 8/6/08
20/F	2	747	\$10,085	\$13.50	Expire on 7/6/08 (海景)
25/F	3 & 5	1,864	\$25,164	\$13.50	Expire on 6/11/08 (海景)

Under Negotiation

Under Offer

Other Information:

Landlord : Century Profit Limited
 Lease Term: 2 - 3 years
 Stamp Duty: Borne by both parties in equal shares
 Management Fee (P.M.): Typical Floor : approx'@\$1.67p.s.f.
 G/F, 3/F & 26/F : approx @1.47p.s.f.
 Cleaning Charges (p.m.): HK\$0.40p.s.f. (1,000 sq.ft. or below) OR Minimum HK\$300, Whichever is the higher
 HK\$0.35p.s.f. (1,001 sq.ft. to 5,000 sq.ft.) OR Minimum HK\$400, Whichever is the higher
 HK\$0.30p.s.f. (5,001 sq.ft. or above) OR Minimum HK\$1750, Whichever is the higher
 Deposit: 3 Months' Rental, Mgnt. Fee, Rates, Gov't Rent & Cleaning Charges
 Person In Charge: Mr. W. H. Ng (Tel 3176 8308)/ Mr. Alan Leung (Tel 3176 8305)
 Mr. Cheung Ka Chun (Tel 31768303)/ Ms. Carrie Lee (Tel 31768302)
 Tenancy Agreement: To be prepared by Mr. Raymond Law (Tel : 2132 8345)/Ms. Eva Chau (Tel : 2132 8594)
 Landlord's Provision: Available at an additional rent @1.80 p.s.f.
 (including false ceiling with light troughs, carpet & split type A/C)
 Management Office: Mr. Andy Wong/Mr. Peter Wan (Tel: 2174 6246)

All prices are subject to change without prior notice

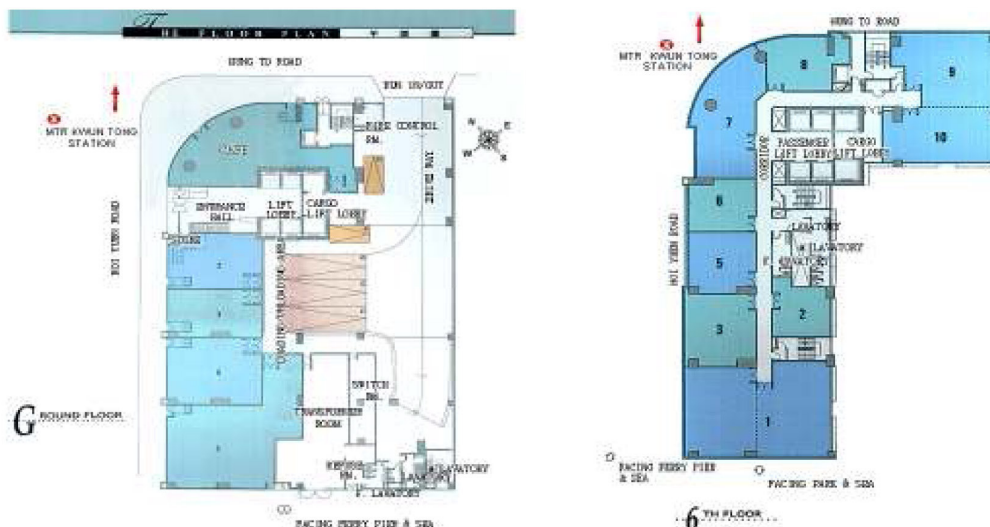

威利廣場 Westley Square

NOT TO SCALE, FOR IDENTIFICATION PURPOSE ONLY

圖中所有數據比例，一概只作參考之用